

**特点**

Features:

- 高触点容量: 200A触点切换能力。
- High contact capacity: 200A of ability to switch contacts.
- 线圈保持电压可降至线圈额定电压的50~55%V, 以达到节能的功效。
- Coil holding voltage can be reduced to 50~55%V of coil rated voltage to achieve energy saving effect.
- 一组常开触点, 触点间距 > 4.0mm。
- A group of normally open contact, contact gap > 4.0mm.
- 符合欧洲光伏标准IEC62109、VDE0126。
- Meet European pv standards IEC62109、VDE0126。

安规认证

Safety Approval

UL, C-UL认证号: 待

UL, C-UL File No: Applying

TUV 认证号: 待

TUV File No: Applying

CQC 认证号: 待

CQC File No: Applying

触点负载

Contact Capacity

型号 Model	200A 型 200A
额定负载 (阻性) Nominal switching capacity (res. load)	接通55A,载流200A,断开55A/800VAC,On 1s/Off 9s,at85°C, 30K ops High operating current 55A,Loadcurrent 200A, Cut off capacity 55A/800VAC,On 1s/Off 9s,at85°C, 30K ops
最大切换电流 Max. switching current	200A
最大切换电压 Max. switching voltage	1000VAC
最大切换功率 Max. switching power	200,000VA

性能参数

Characteristic Data

触点材料 Contact arrangement	银合金 Silver alloy	
接触电阻 contact resistance	1mΩ/at 20A (max) 1mΩ/at 20A (max)	
吸合时间 Operate time (at nominal volt.)	30msec. Max. 30msec. Max.	
释放时间 Release time (at nominal volt.)	10msec. Max. 10msec. Max.	
绝缘电阻 insulation resistance	1000MΩ Min.(DC500V) 1,000MΩ Min.(DC500V)	
介质耐压 Initial dielectric strength	触点与触点间: AC 2000V,50/60Hz 1min. Between open contacts: AC2,000V, 50/60Hz 1min. 触点与线圈间: AC 5000V,50/60Hz 1min. Between coil and contact: AC5,000V, 50/60Hz 1min	
抗振动 Vibration resistance	耐久 Functional	10~55Hz, 双振幅 1.0 mm 10~55Hz at double amplitude of 1.0 mm
	误动作 Destructive	10~55Hz, 双振幅 1.0 mm 10~55Hz at double amplitude of 1.0 mm
抗冲击 Shock resistance	耐久 Functional	100G Min. 100G Min.
	误动作 Destructive	10G Min. 10G Min.
寿命 Endurance	机械寿命 (每小时9,000次) Mechanical (at 9000 ops./h)	1,000,000 次 1,000,000 cycles
环境温度 Ambient temperature	-40°C~+85°C(不冷凝) -40°C~+85°C (no condensation)	
重量 Unit weight	约215g Approx. 215g	

线圈参数 (at 20°C)

Coil Data (at 20°C)

200A type

200A type

额定电压 Nominal voltage (VDC)	额定电流 Nominal operating current ±10% (mA)	线圈电阻 Coil resistabce ±10% (Ω)	吸合电压 ⁽¹⁾ Pick-up voltage ⁽¹⁾ (Max.)	释放电压 Drop-out voltage (Min.)	保持电压 ⁽²⁾ Keep voltage ⁽²⁾	额定功率 Nominal operating power
12	250	48	额定电压的 Nominal voltage 75 %	额定电压的 Nominal voltage 5 %	额定电压的 Nominal voltage 50~55 %	3W
24	125	192				

备注: (1)继电器施加全额线圈电压维持200ms.

Comment: (1)Relays apply full coil voltage to maintain 200ms

(2)线圈保持电压是线圈激励电压维持200ms之后, 降至额定线圈电压的50~55%.

(2)The coil holding voltage is 50~55% of the rated coil voltage after the coil excitation voltage is maintained for 200ms

(3)继电器线圈不允许长时间施加超过保持电压的上限值,防止继电器过热烧毁.

(3)Relay coils are not allowed to exceed the upper limit of the holding voltage for long periods of time to prevent the relay from overheating and burning out

安全认证负载

Safety Approval Ratings

认证类别 Approval	TUV	CQC	UL/CUL
认证号码 File No.			
认证负载 Approved ratings	待 Applying	待 Applying	待 Applying

订货标记

Ordering Information

型号命名规则 Nomenclature
<p>SPV 200 -M <input type="checkbox"/> <input type="checkbox"/></p>
<p>客户特性号 无: 无客户特殊要求 Special Parameter: Nil-Standard type 数字或字母: 客户特殊要求, 与结构无关 Letter or number: Special requirement</p>
<p>触点材质 1-AgSnO2+AgNi 2-AgSnO2+AgCuO Contact material: 1- AgSnO2+ AgNi 2- AgSnO2+ AgCuO</p>
<p>线圈电压 12: 12VDC The coil voltage: 24: 24VDC</p>
<p>触点形式 M: 1组常开 Contact form: M-Form A</p>
<p>负载类型 200-200A The load type: 200-200A</p>
<p>基本型号 SPV Type designation: SPV</p>

外形尺寸
Outline Dimensions

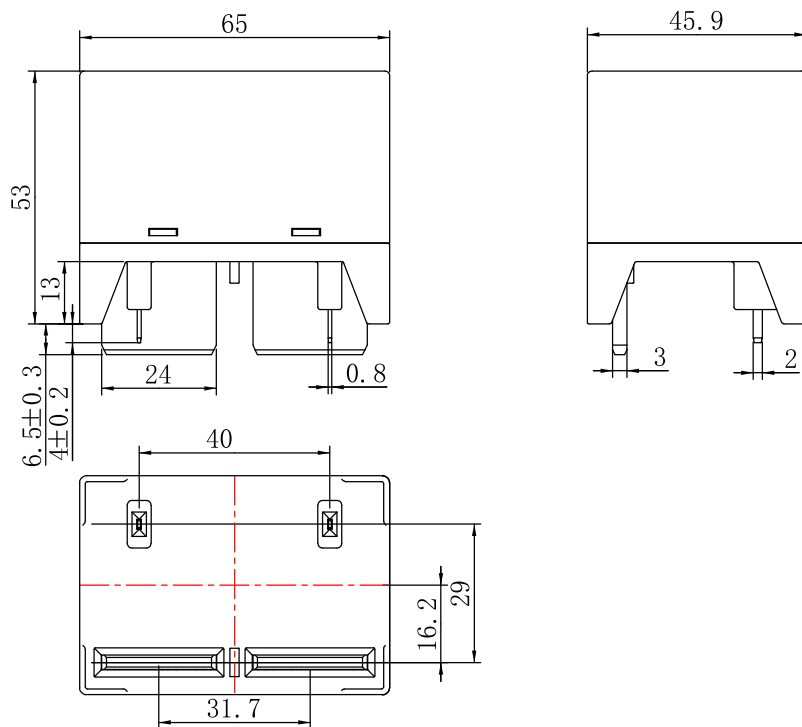

接线图
wiring diagram

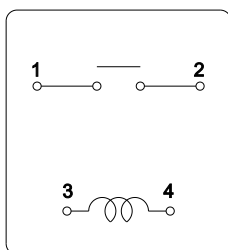

未标注尺寸公差：
 < 1mm: ±0.2mm
 1~5mm: ±0.3mm
 > 5mm: ±0.4mm
 注：1、引出脚尺寸为预焊前尺寸
 2、安装孔尺寸公差：±0.1mm
 Unless otherwise specified:
 If dimension < 1mm, tolerance: ±0.2mm;
 If dimension 1~5mm, tolerance: ±0.3mm;
 If dimension > 5mm, tolerance: ±0.4mm.

Note: 1. Extended terminal dimension is dimension before soldering.
 2. Tolerance of P.C.B. layout: ±0.1mm.

声明:

本产品规格书仅供客户使用时参考，若有更改，恕不另行通知。
 对三友而言，不可能评定继电器在每个具体应用领域的所有性能参数要求，因而客户应该根据具体的使用条件选择与之相匹配的产品，若有疑问，请与三友联系获取更多的技术支持。但产品选型责任仅由客户负责。

三友联众集团股份有限公司版权所有，本公司保留所有权利。

Disclaimer:

This datasheet is the customers' reference. All the specification are subject to change without notice.
 We could not evaluate all the performance and all the parameters for every possible application. Thus the user should in a right position to choose the suitable product for their own application. If there is any query, please contact Sanyou for the technical service. However it is the user's responsibility to determine which product should be used only.

©

Sanyou Corporation Limited, All rights of Sanyou to reserved