

# ZMCT156 Current Transformer

Small size, high accuracy, good consistency, Applied to the power frequency 50(60)Hz multifunction meter

## Structural parameter:

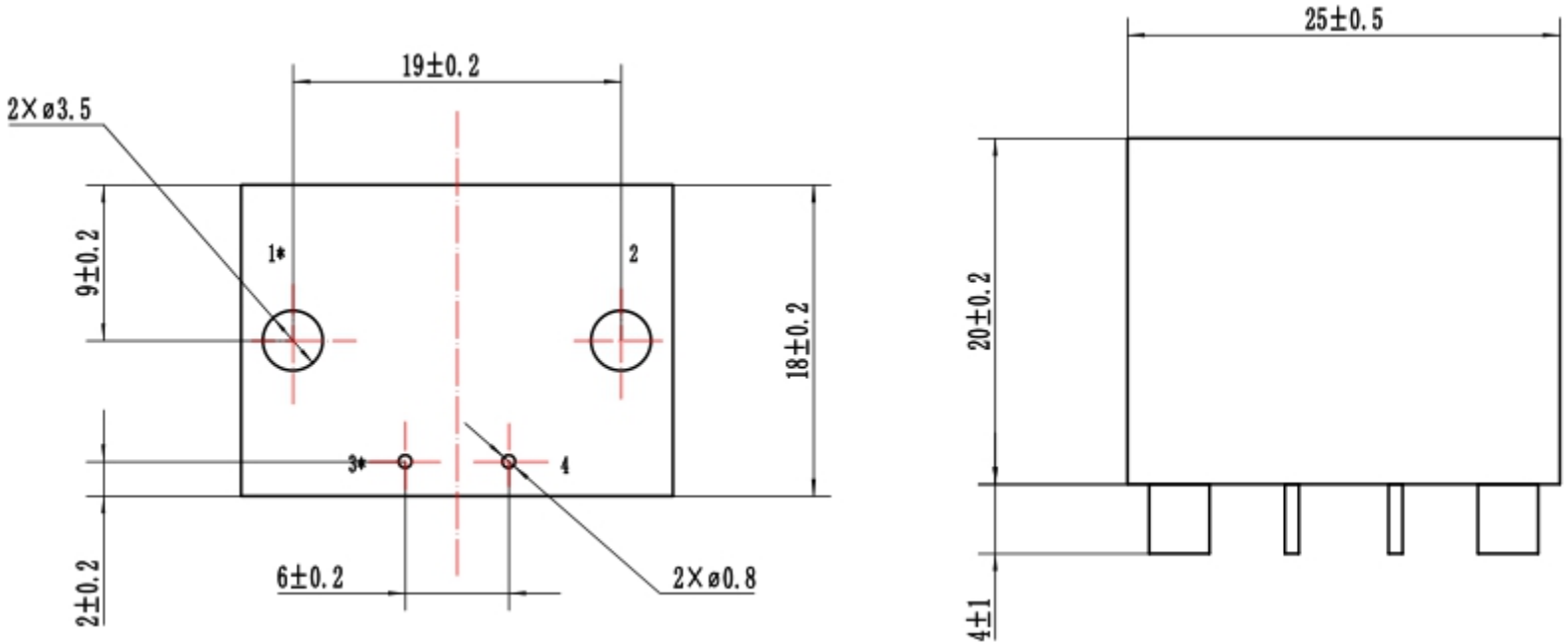

Note:

- 1) Unit: mm
- 2) Current Direction: "\*" means "same polarity"

## Schematic Diagram:

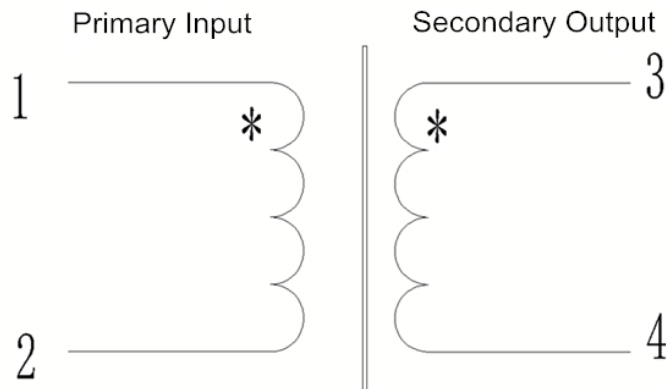

**Main technical parameters:**

Model	ZMCT156
input current	0~35A (sampling resistor 56Ω)
Rated output current	2.5mA at input 5A
Turns ratio	2000:1
Phase angle error	≤30' (Input 5A, sampling resistor 56Ω)
Accuracy class	0.5
Linearity	0.5% (5% dot ~120% dot of 5A)
Permissible error	-0.5%≤f≤+0.5% (Input 5A, sampling resistor 56Ω)
Isolation voltage	3000V
application	High precision measurement of current and power
Installation	PCB mounting (Pin length>3mm)
encapsulation	Epoxy
Operating temperature	-40℃~+85℃